

DIAPHRAGM VALVE PARTS

RISING HANDWHEEL

SERIES 'S2K'

SERIES 'G2K'

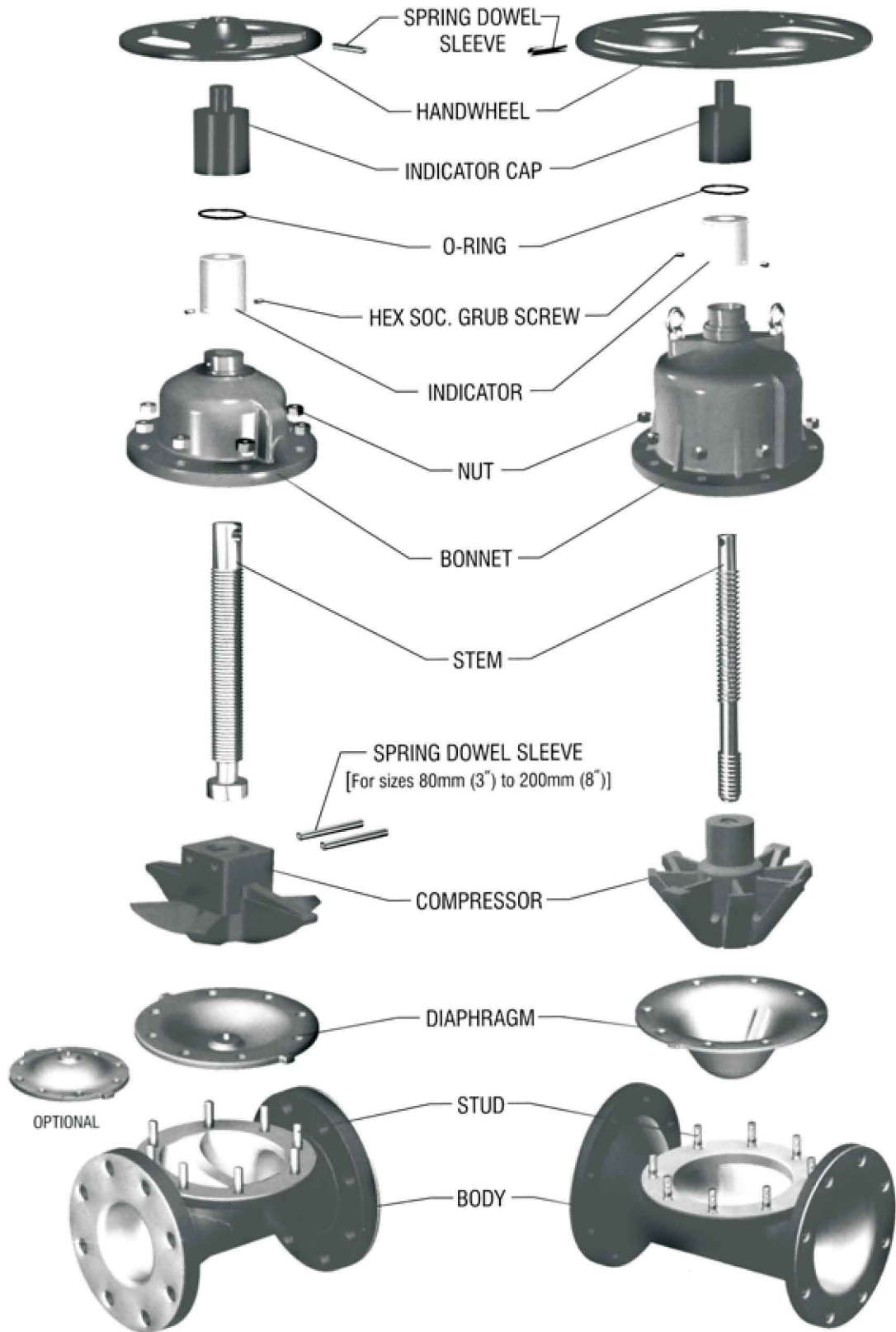

DIAPHRAGM VALVES

SERIES 'S2K' & 'G2K' RISING HANDWHEEL

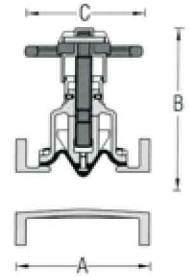
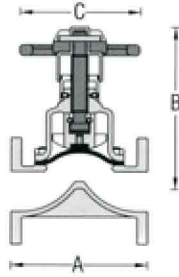

DESIGN STD : BS EN 13397 TESTING STD : EN 12266 - 1

		Test Pressure in bar (psi)					
		Series 'S2K'			Series 'G2K'		
Pressure rating 2)		16	10	7	10	7	5
Hyd. Shell		24 (348)	15 (218)	10.5 (152)	15 (218)	10.5 (152)	6 (87)
Seat		16 (232)	10 (145)	7 (102)	10 (145)	7 (102)	5 (73)
Air Seat			5 (73)			5 (73)	

Dimensions are in mm (inch)

← BS →						← DIN →						← MSS →					
← A →						← A →						← A →					
← BS →						← DIN →						← MSS →					
SIZE	Unlined	Rubber Lined	PFA* Lined	Unlined & Lined	MSS SP-88 PFA Lined	B	C	← W1 1) →			B	C	← W1 1) →				
mm (inch)								BS	DIN	MSS			BS	DIN			
15 (1/2)	108 (4.3)	114 (4.5)	114 (4.5)	130 (5.1)	108 (4.3)	105 (4.1)	80 (3.1)	2.5 (5.5)	2.8 (6.2)	2.5 (5.5)	105 (4.1)	80 (3.1)	2.4 (5.3)	2.6 (5.7)			
20 (3/4)	117 (4.6)	123 (4.8)	123 (4.8)	150 (5.9)	149 (5.9)	115 (4.5)	80 (3.1)	2.6 (5.7)	3.2 (7.0)	3.0 (6.6)	115 (4.5)	80 (3.1)	2.8 (6.2)	3.0 (6.6)			
25 (1)	127 (5.0)	133 (5.2)	133 (5.2)	160 (6.3)	149 (5.9)	132 (5.2)	120 (4.7)	3.5 (7.7)	4.2 (9.3)	4.0 (8.8)	135 (5.3)	120 (4.7)	4.2 (9.3)	4.6 (10.1)			
32 (1 1/4)	146 (5.7)	152 (6.0)	152 (6.0)	180 (7.1)	152 (6.0)	140 (5.5)	120 (4.7)	4.5 (9.9)	5.5 (12.1)	5.0 (11.0)	135 (5.3)	120 (4.7)	4.5 (9.9)	5.5 (12.1)			
40 (1 1/2)	159 (6.3)	165 (6.5)	165 (6.5)	200 (7.9)	176 (6.9)	180 (7.1)	150 (5.9)	7.0 (15.4)	8.0 (17.6)	7.5 (16.5)	135 (5.3)	120 (4.7)	5.5 (12.1)	6.0 (13.2)			
50 (2)	190 (7.5)	196 (7.7)	196 (7.7)	230 (9.1)	202 (7.9)	210 (8.3)	150 (5.9)	10 (22)	15 (33)	11 (24)	175 (6.9)	180 (7.1)	10 (22)	11 (24)			
65 (2 1/2)	216 (8.5)	222 (8.7)	222 (8.7)	290 (11.4)	222 (8.7)	235 (9.3)	180 (7.1)	15 (33)	19 (42)	16 (35)	200 (7.9)	180 (7.1)	16 (35)	18 (39)			
80 (3)	254 (10.0)	260 (10.2)	260 (10.2)	310 (12.2)	264 (10.4)	305 (12.0)	250 (9.8)	22 (49)	26 (57)	23 (51)	260 (10.2)	250 (9.8)	25 (55)	28 (62)			
100 (4)	305 (12.0)	313 (12.3)	311 (12.2)	350 (13.8)	329 (12.9)	340 (13.4)	250 (9.8)	38 (84)	43 (95)	38 (84)	275 (10.8)	250 (9.8)	33 (73)	37 (82)			
125 (5)	356 (14.0)	364 (14.3)	362 (14.2)	400 (15.7)	416 (16.4)	420 (16.5)	315 (12.4)	63 (139)	69 (152)	71 (156)	340 (13.4)	315 (12.4)	57 (126)	64 (141)			
150 (6)	406 (15.9)	414 (16.3)	412 (16.2)	480 (18.9)	416 (16.4)	490 (19.3)	360 (14.2)	92 (203)	107 (236)	94 (207)	440 (17.3)	360 (14.2)	67 (148)	82 (181)			
200 (8)	521 (20.5)	529 (20.8)	527 (20.7)	600 (23.6)	530 (20.9)	645 (25.4)	470 (18.5)	164 (361)	186 (410)	167 (368)	495 (19.5)	470 (18.5)	116 (256)	136 (300)			

* Series 'S2K' only

Materials

Body/Bonnet/Compressor	Cast Iron ASTM A126 Class B / EN-1561 No.EN-JL1040 / S G Iron EN-1563 No.EN-JS1024 / ASTM A395 Gr. 60-40-18 / 30% Cr. Cast Steel ASTM A743 Gr. CC50 / ASTM A216 Gr. WCB / Stainless Steel ASTM A351 Gr. CF8 / CF8M
Body Lining	Ebonite / Natural / Butyl / Neoprene / EPDM / Nitrile, other Elastomers & even PFA, PTFE, PP etc.
Diaphragm	Natural / Butyl / Neoprene / EPDM / Nitrile / Hypalon / Viton / Silicon / PTFE etc.
Stem	Steel ASTM A276 TYPE 410
Connecting studs / nuts	Steel Gr. 4.6 / 4
Handwheel	Cast Iron ASTM A126 Class B / EN-1561 No.EN-JL1040
Surface Protection for Cast Iron and Cast Carbon Steel Valves	Prime Coat : Chlorine free with modified alkyd resin unobjectionable in physiological and toxicological respects. Additional external coating : Black Stoving Enamel

1) Net in Kg. (lbs) approx. (without obligation) 2) Pressure Rating : Series 'S2K' for Sizes 15mm (1/2") to 50mm (2") - 16 bar (232 psi), for Sizes 65mm (2 1/2") to 150mm (6") - 10 bar (145 psi), for Size 200mm (8") - 7 bar (102 psi). Series 'G2K' for Sizes 15mm (1/2") to 100mm (4") - 10 bar (145 psi), for Size 125mm (5") - 7 bar (102 psi), for Sizes 150mm (6") to 200mm (8") - 5 bar (73 psi).
 ■ Halar coating also available on request. ■ Valves Flanges can be drilled to suit ASME / BS / DIN / JIS. ■ Please Specify Working Pressure, Temperature & Service conditions. ■ Valves can be supplied with Pad - lock, Chainwheel, Travel Stop Arrangement, Extended Stem, Electrical / Pneumatic Actuators & other accessories like Limit Switch, Solenoid Valve, Air Filter Regulator, Positioner etc.
 ■ Other Materials not mentioned above available on request.

DIAPHRAGMS

SERIES 'S2K' & 'G2K'

"Insist only on genuine  Diaphragms"

BDK elastomer technology has led to the development of a range of diaphragm grades to suit the widest variety of process applications.



SERIES 'S2K' CLOSE TYPE



SERIES 'S2K' OPEN TYPE



SERIES 'S2K' PTFE WITH ELASTOMER PAD



SERIES 'G2K' CLOSE TYPE



TYPICAL SELECTION AND APPLICATION

GRADE	MATERIAL	APPLICATION	TEMP RANGE °C (°F)	HARDNESS N SHORE - A	UTS Kg/cm ² (psi)	COLOUR CODE
A	Natural Rubber	Mildly acid Resistant	-30 To 80 (-22 To 176)	65 - 75	170 (2418)	White
AA	Natural Rubber	Abrasion Resistant	-30 To 80 (-22 To 176)	60 - 70	150 (2134)	White
AS	Natural Rubber	Highly Abrasion Resistant	-30 To 80 (-22 To 176)	45 - 55	150 (2134)	White
WA	White Natural Rubber	Food & Pharmaceuticals	-10 To 80 (14 To 176)	55 - 65	100 (1422)	White
N	Neoprene Rubber	Diluted Acid Resistant	-25 To 95 (-13 To 203)	60 - 70	120 (1707)	Red
NWT	Neoprene Rubber	Water Treatment	-25 To 95 (-13 To 203)	60 - 70	120 (1707)	Red
NCMS	Neoprene Rubber	Caustic Soda	-25 To 95 (-13 To 203)	60 - 70	120 (1707)	Red
B	Butyl Rubber	Steam Sterilisation	-25 To 120 (-13 To 248)	60 - 70	100 (1422)	Blue
WB	White Butyl Rubber	Food & Pharmaceuticals	-25 To 105 (-13 To 221)	55 - 65	80 (1138)	Blue
R	Nitrile Rubber	Oils and Fats	-10 To 90 (14 To 194)	65 - 75	120 (1707)	Yellow
H	Hypalon Rubber	Acid Resistant	-15 To 100 (5 To 212)	60 - 70	80 (1138)	Green
EP	Ethylene Propylene	Radio Active Materials	-30 To 150 (-22 To 302)	65 - 75	80 (1138)	Orange
V	Viton Rubber	Aromatics Chlorine	-5 To 150 (23 To 302)	70 - 80	70 (996)	Pink
S	Silicon Rubber	High Temperatures	-100 To 250 (-148 To 482)	55 - 65	70 (996)	Black
T	PTFE	All Chemicals and Food	-30 To 175 (-22 To 347)	-	-	-

TYPICAL DATA FOR FLUOROPOLYMER RESIN

RESIN	TECHNICAL NAME	TRADE NAME	TEMP RANGE °C (°F)	MELTING PT °C (°F)
PTFE	Poly Tetra Fluoro Ethylene	Teflon	-50 To 260 (-58 To 500)	327 (621)
PFA	Per Fluoro Alkoxy	Teflon	-50 To 260 (-58 To 500)	310 (590)
ETFE	Ethylene Tetra Fluoro Ethylene	Tefzel	-50 To 180 (-58 To 356)	240 (464)
FEP	Fluorinated Ethylene Propylene	Teflon	-50 To 200 (-58 To 392)	265 (509)
ECTFE	Ethylene Chloro Trifluoro Ethylene	Halar	-50 To 170 (-58 To 338)	240 (464)
PVDF	Poly Vinylidene Fluoride	Kynar	-50 To 140 (-58 To 284)	160 (320)
PP	Poly Propylene	-	-50 To 120 (-58 To 248)	150 (302)

General Application : Highly corrosive fluids, acids, alkalies, chlorides, semiconductors, etc.

Every Genuine BDK Diaphragm has moulded in details.

1) The  LOGO. 2) Size in mm (inch). 3) Diaphragm grade. 4) Month and Year of manufacture. 5) Batch No. 6) Material code.

■ For Series 'G2K' Hardness will be 10° less than the specified above. ■ Viton, Silicon & PTFE not available for Series 'G2K'.